

Gallery of 3D prints

Showcase of my successful 3D prints contain next photogallery. As inspiration for my prints was used:

- searching in thingiverse – all collections on my profile can be accessed by link <https://www.thingiverse.com/ciljak/collections>
- my own designs

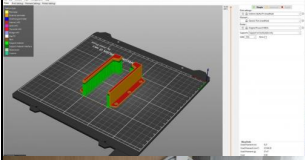

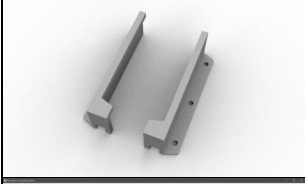
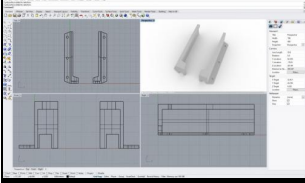
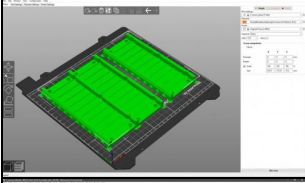
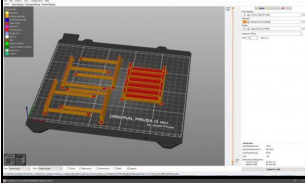
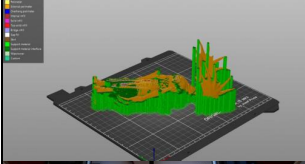
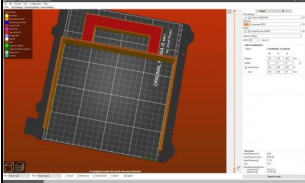
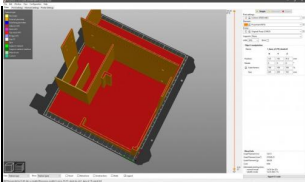

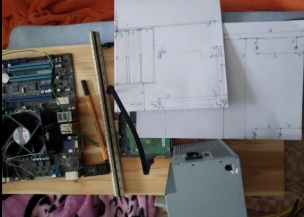
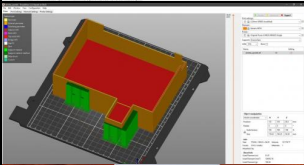
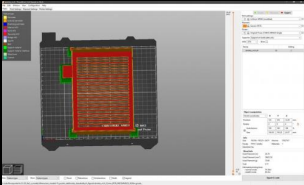
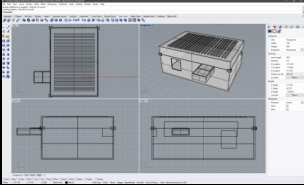
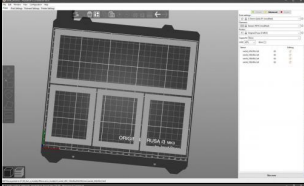
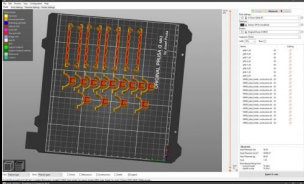
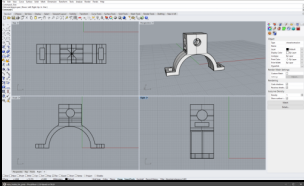
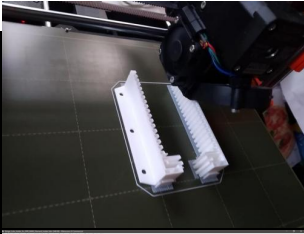

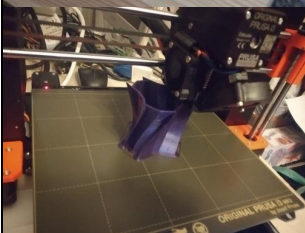
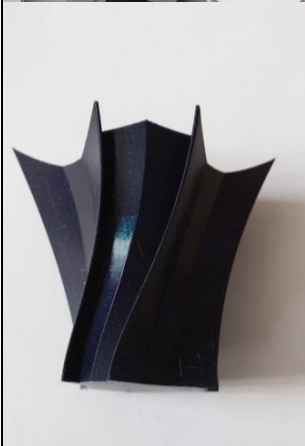
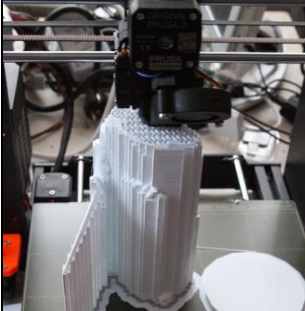
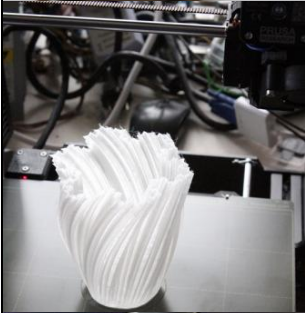

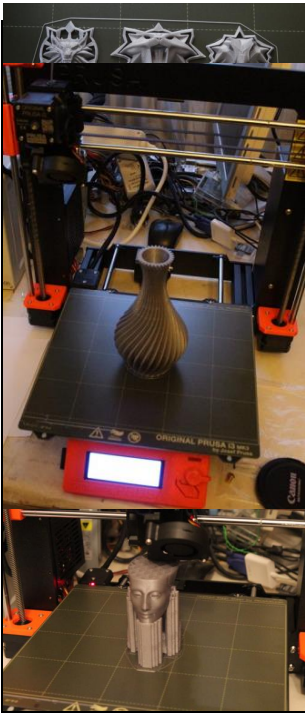

PrusaSlicer-2.5.0-win64-201909160913 based on Slic3r

File Edit Window View Configuration Help
Printer Filament Settings Filament Settings Printer Settings

Print settings:

Simple Advanced Expert

0.15mm QUALITY MK3

Filament: Generic PLA

Printer: Original Prusa i3 MK3S

Supports: None

Infill: 15% Bim:

Object manipulation

Name: Pentomino_04.stl

	X	Y	Z
Position:	128.29	52.3	5.72 mm
Rotate:	0	0	0 °
Scale factors:	100	100	100 %
Size:	145.67	94.07	11.43 mm

Slice now

